









# DEF CON 31 HDA INFOPACK



## PROVISIONS FOR DEF CON ATTENDEES WITH DISABILITIES

**YOU MAY USE ANY WALL OUTLET IN THE CONVENTION AREA TO RECHARGE THEIR ASSISTIVE DEVICES SO LONG AS IT CAN BE DONE SAFELY. DEF CON ASKS ALL ATTENDEES TO ALLOW ATTENDEES NEEDING TO RECHARGE THEIR ASSISTIVE DEVICES TO HAVE PRIORITY TO OUTLETS.**

**YOU HAVE THE OPTION TO REQUEST A DEF CON GOON TO ESCORT YOU TO THE HEAD OF ANY REGISTRATION LINE OR OTHER DEF CON RELATED LINE.**

**IF YOU HAVE A PERSONAL ASSISTANT WITH YOU EXPRESSLY TO ASSIST YOU WITH YOUR DISABILITY PLEASE INFORM REGISTRATION WHEN YOU REGISTER.**

**IF YOU HAVE A SERVICE ANIMAL HOTEL STAFF CAN DIRECT YOU TO THE SERVICE ANIMAL RELIEF AREA. IF YOUR SERVICE ANIMAL HAS AN ACCIDENT PLEASE INFORM ANY DEF CON GOON OR HOTEL STAFF MEMBER FOR ASSISTANCE.**

**IN EVERY SPEAKER AREA A NUMBER OF SEATS IN THE FRONT ROW WILL BE RESERVED FOR ATTENDEES WITH DISABILITIES. THESE WILL BE MARKED BY A DEF CON HDA CARD. DEF CON ASKS ALL ATTENDEES TO HONOR THESE RESERVED SEATS OR TO MAKE SEATS AVAILABLE AS NEEDED.**



# MASKING



**WEARING A MASK WILL BE OPTIONAL THIS YEAR FOR DEF CON 31.**

**THE OFFICIAL POLICY CAN BE SEEN AT : [HTTPS://DEFCON.ORG/HTML/DEFCON-31/DC-31-COVID.HTML](https://defcon.org/html/defcon-31/dc-31-covid.html)**

**PROTECTING THE COMMUNITY IS OUR FIRST PRIORITY, AND WE WANT TO MAKE SURE THAT EVERYONE IS AS SAFE AS WE CAN MAKE THEM. EVERYONE INCLUDES THE HEALTHY, THE VULNERABLE AND THOSE WHO HAVE IMMUNE COMPROMISED LOVED ONES THEY NEED TO PROTECT.**

**WE KNOW THERE ARE PEOPLE OUT THERE WHO PUNCH DOWN ON MASK WEARERS, BUT WHO SUPPORTS THEM?**

**NEXT TIME YOU SEE A PERSON WEARING A MASK, THROW THEM THE VULCAN HAND SIGN. 'LIVE LONG AND PROSPER'. QUIETLY BUT FIRMLY SUPPORT THEM.**





# DEF CON 31 HDA INFOPACK



## PROVISIONS FOR DEF CON ATTENDEES WITH DISABILITIES

**IF YOU ENCOUNTER A SITUATION IN WHICH YOU ARE UNABLE TO ACCESS ANY PART OF DEF CON PLEASE ASK ANY DEF CON GOON FOR ASSISTANCE. HDA IS AVAILABLE THE HDA COORDINATOR WILL BE AVAILABLE BY RADIO TO ASSIST AND TO COORDINATE WITH THE HOTEL STAFF IF NEEDED.**

**IF YOU ARE A SPEAKER AND NEED ASSISTANCE WITH ACCESSING THE SPEAKING AREA PLEASE LET OPERATIONS KNOW AHEAD OF TIME. IF YOU DISCOVER AN ISSUE AT THE TIME OF YOUR TALK ASK ANY DEF CON GOON FOR ASSISTANCE. THE HDA COORDINATOR WILL BE AVAILABLE BY RADIO TO ASSIST AND TO COORDINATE WITH THE HOTEL STAFF IF NEEDED.**

**PLEASE REPORT ANY INSTANCES OF HARASSMENT, ABUSE OR OTHER OUT OF LINE BEHAVIOR TO THE DEF CON HDA TEAM MEMBER, THE DEF CON INFO BOOTH, ANY DEF CON GOON, OR HOTEL RESOURCES YOU FEEL MOST COMFORTABLE WITH.**

**WHILE WE STRIVE TO MAKE THIS COMPLETE AND COMPREHENSIVE PLEASE UNDERSTAND THAT WITH A CONVENTION OF THIS SIZE CHANGES CAN AND WILL BE MADE CONSTANTLY AND THE HDA TEAM WILL DO THEIR BEST TO KEEP ATTENDEES INFORMED OF ALL CHANGES .**

**THANK YOU FOR YOUR HELP IN MAKING DEF CON AWESOMELY ACCESSABLE !!**



# HDA COMMUNITY ROOMS



**THANKS TO DEF CON FOR GRANTING HDA THE STATUS OF A DEF CON COMMUNITY!**

**THE HDA COMMUNITY SPACES WILL BE LOCATED IN THE HARRAHS CORPORATE CONVENTION SPACE AND WILL BE OPEN TO ALL ATTENDEES, WITH A FOCUS ON PROVIDING A COMMUNITY SPACE FOR ATTENDEES WITH ADA NEEDS.**

**THE HDA COMMUNITY ROOMS WILL BE PROVIDING THE FOLLOWING :**

- **A SPACE FOR ATTENDEES WITH ADA REQUIREMENTS TO SOCIALIZE**
- **A SPACE FOR RECHARGING MOBILITY AIDS**
- **A "SAFE HARBOR" ROOM : A SEMI-PRIVATE SPACE FOR ADA NEEDS**
- **TALKS AND ACTIVITIES DIRECTED TOWARDS ADA TOPICS**
  - **TALK : HACKING POWER WHEELCHAIRS**
  - **TALK : LED LIGHTS FOR FUN AND SAFETY**
  - **DECK OUT MY RIDE : DECORATE YOUR ASSISTIVE DEVICES WITH STICKERS, GLOWSTICKS, FLAGS, OR SCHWAG!**
  - **ANALOG SYNTH JAM SESSION : COME HEAR WHAT THE DEF CON COMMUNITY SOUNDS LIKE**
  - **DELCHI PRESENTS: GEEK TRIVIA WITH PRIZES FROM ADAFRUIT!**

**[HTTP://ADAFRUIT.COM](http://adafruit.com) -- PROJECT KITS AND MORE !**

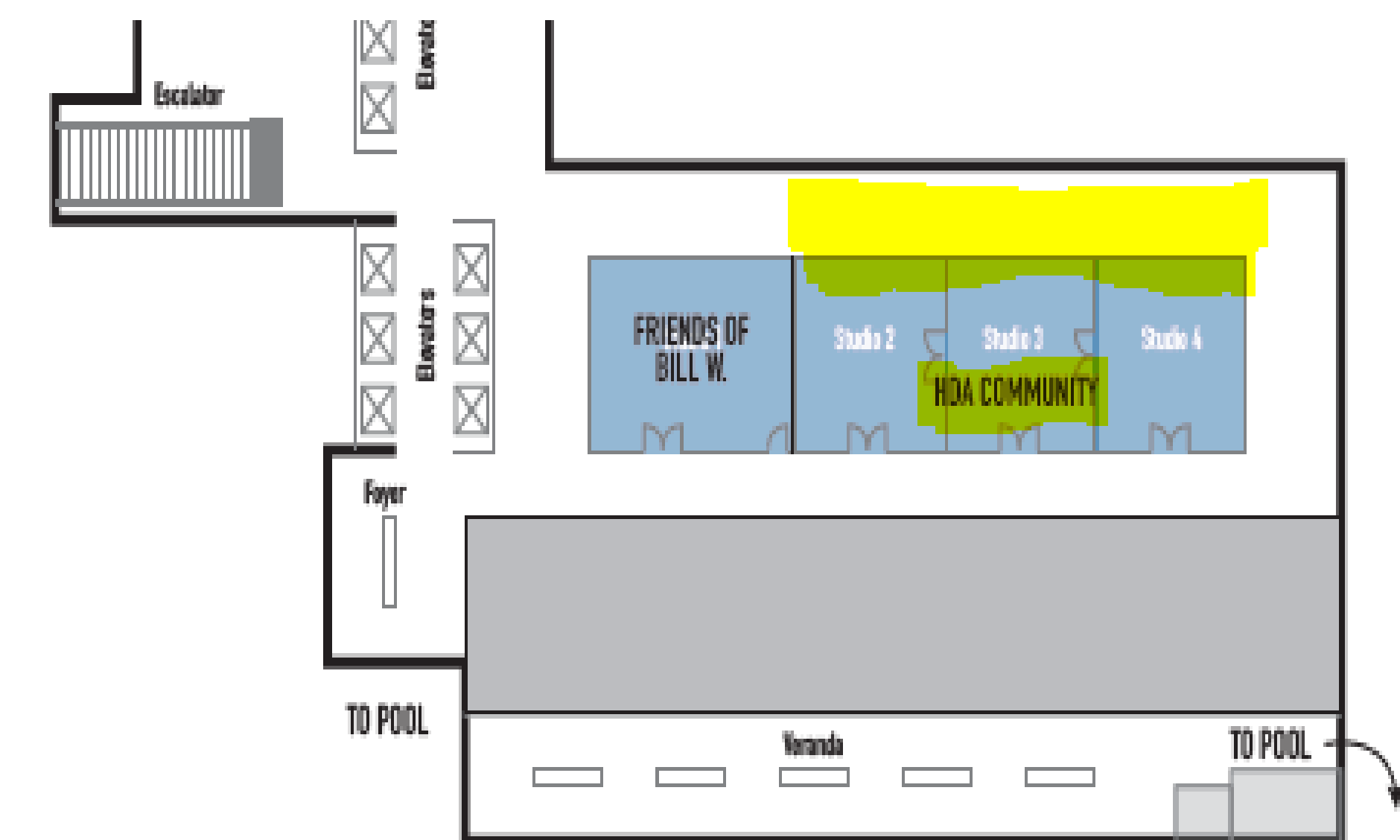



# LOCATION & VENUE MAPS





# DEF CON HDA MAPS



## CAESARS FORUM

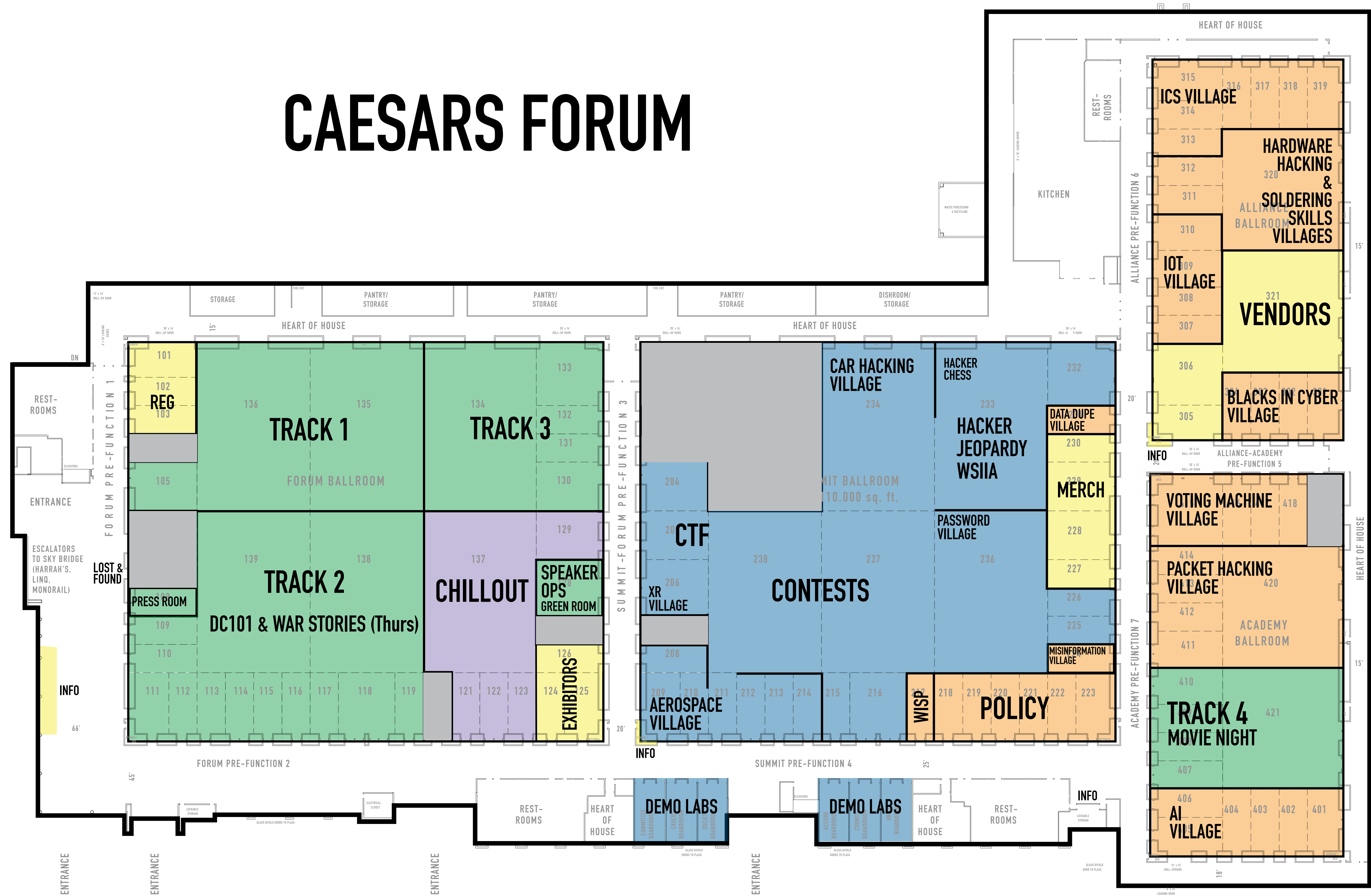



# DEF CON HDA MAPS



## FLAMINGO

## EXECUTIVE CONFERENCE CENTER

### LOWER LEVEL

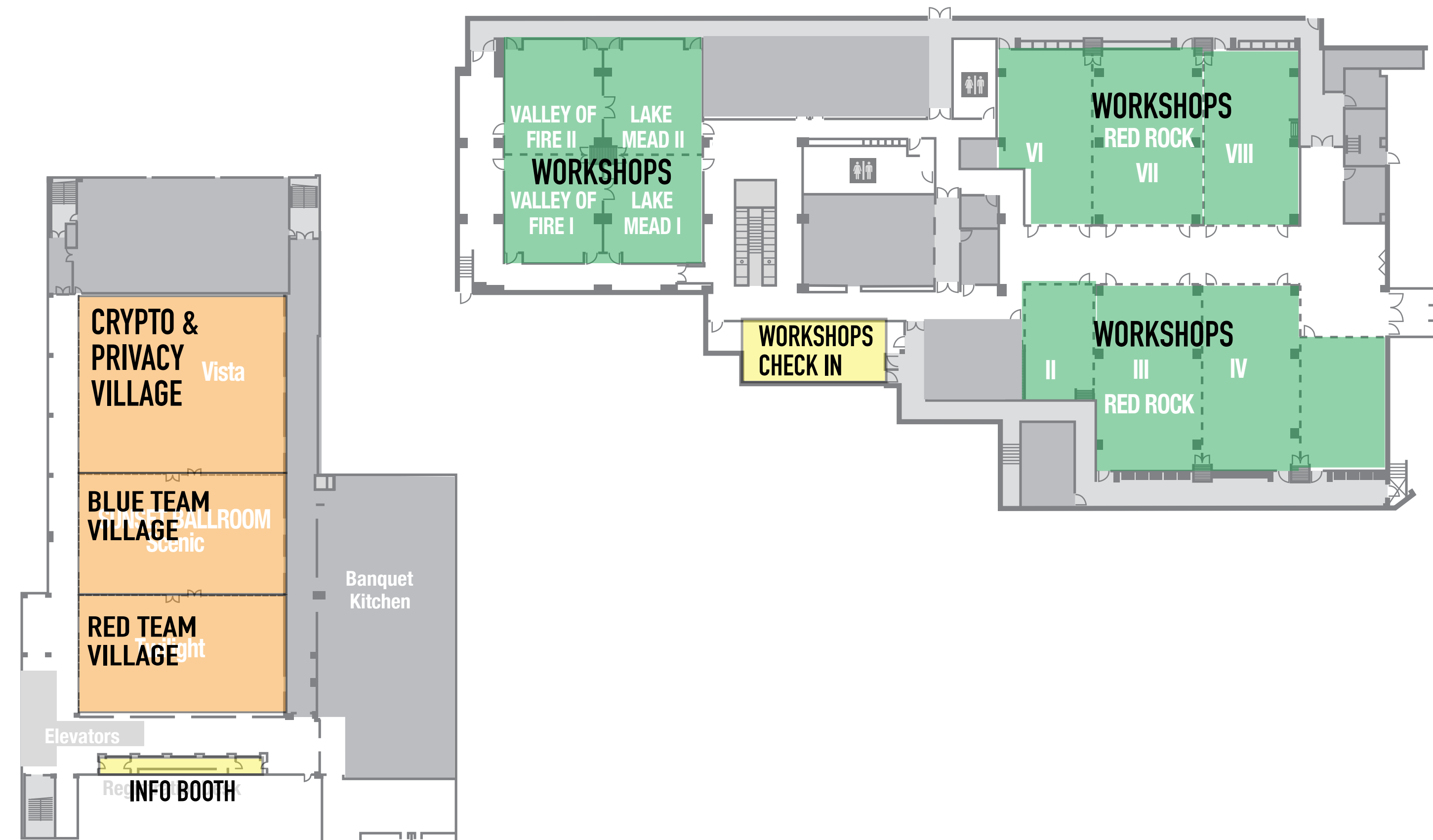

## CORPORATE CONVENTION CENTER

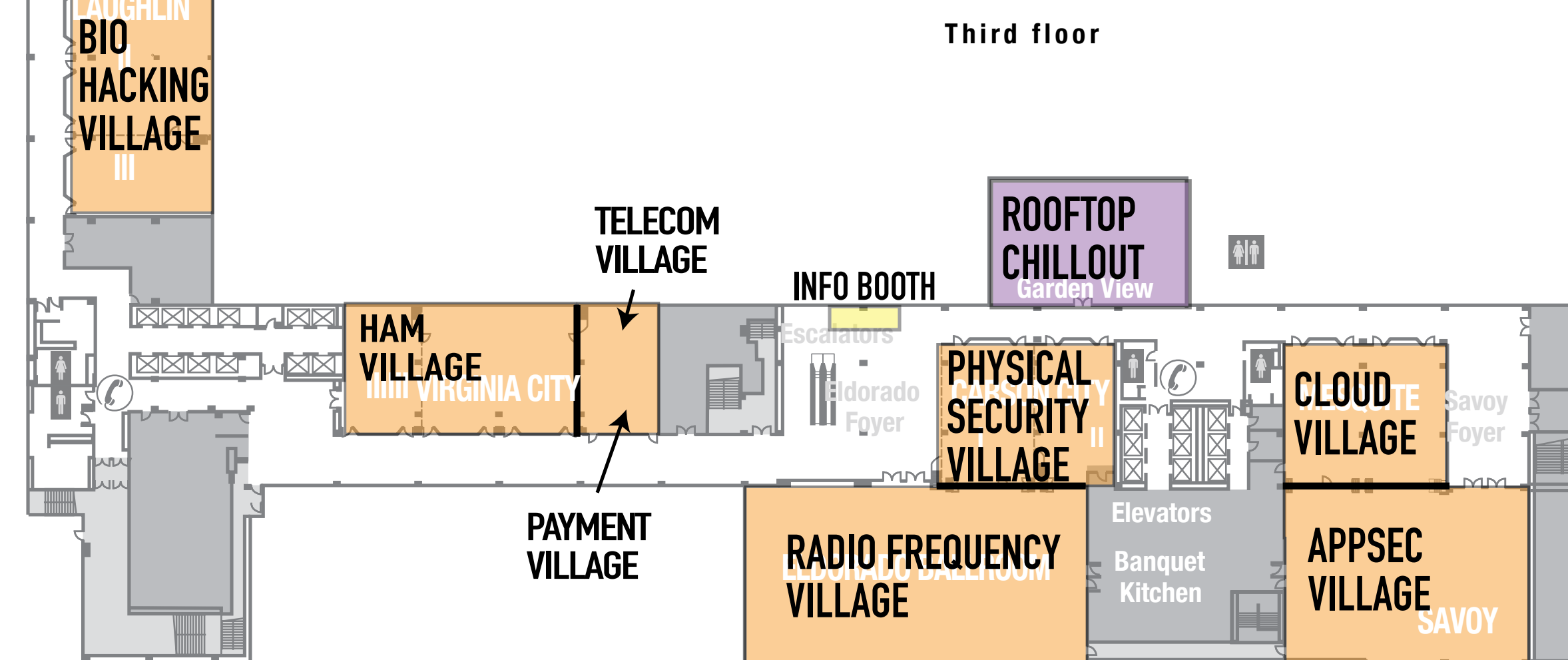



# DEF CON HDA MAPS

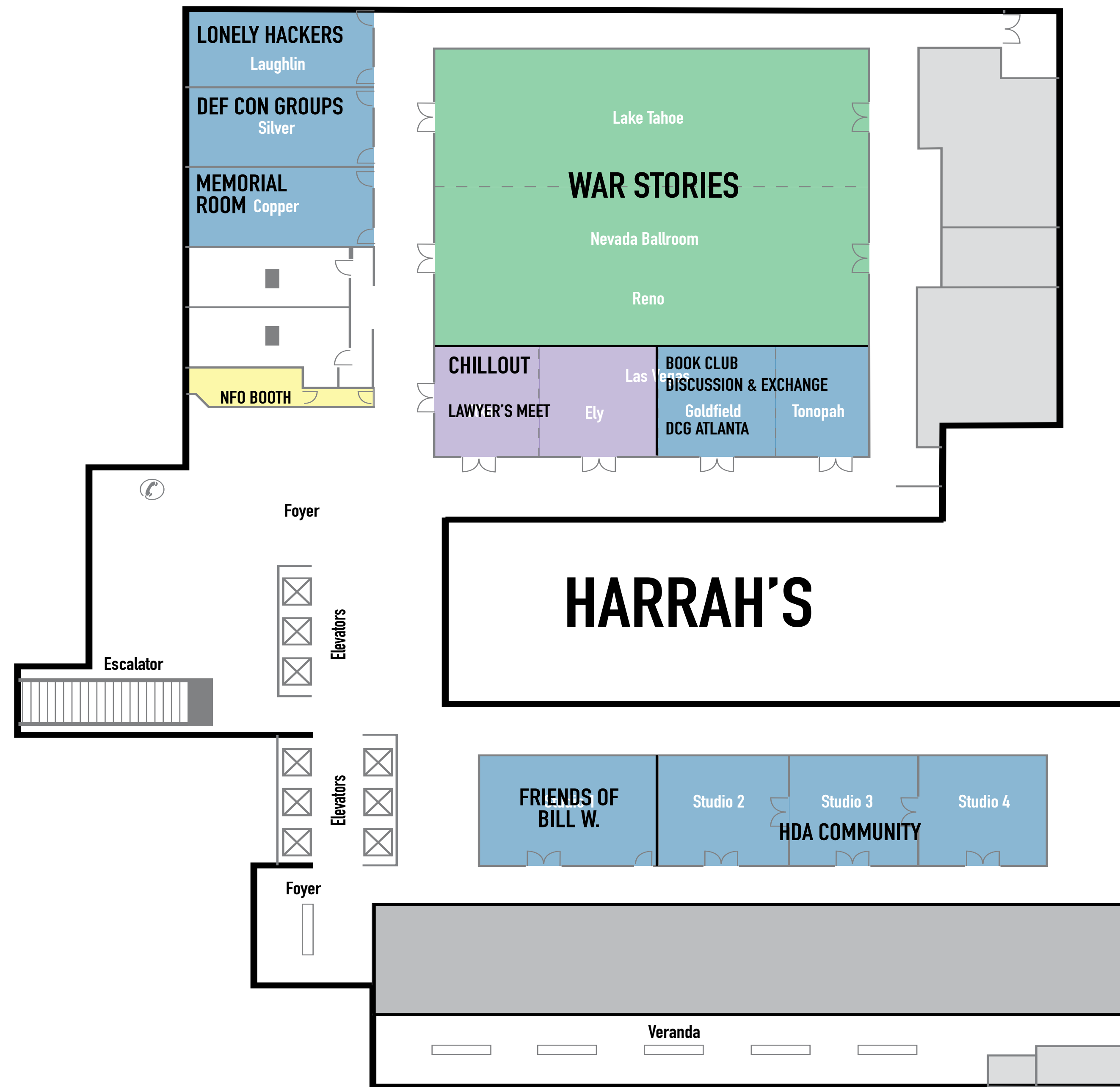



# DEF CON HDA MAPS



## LINQ

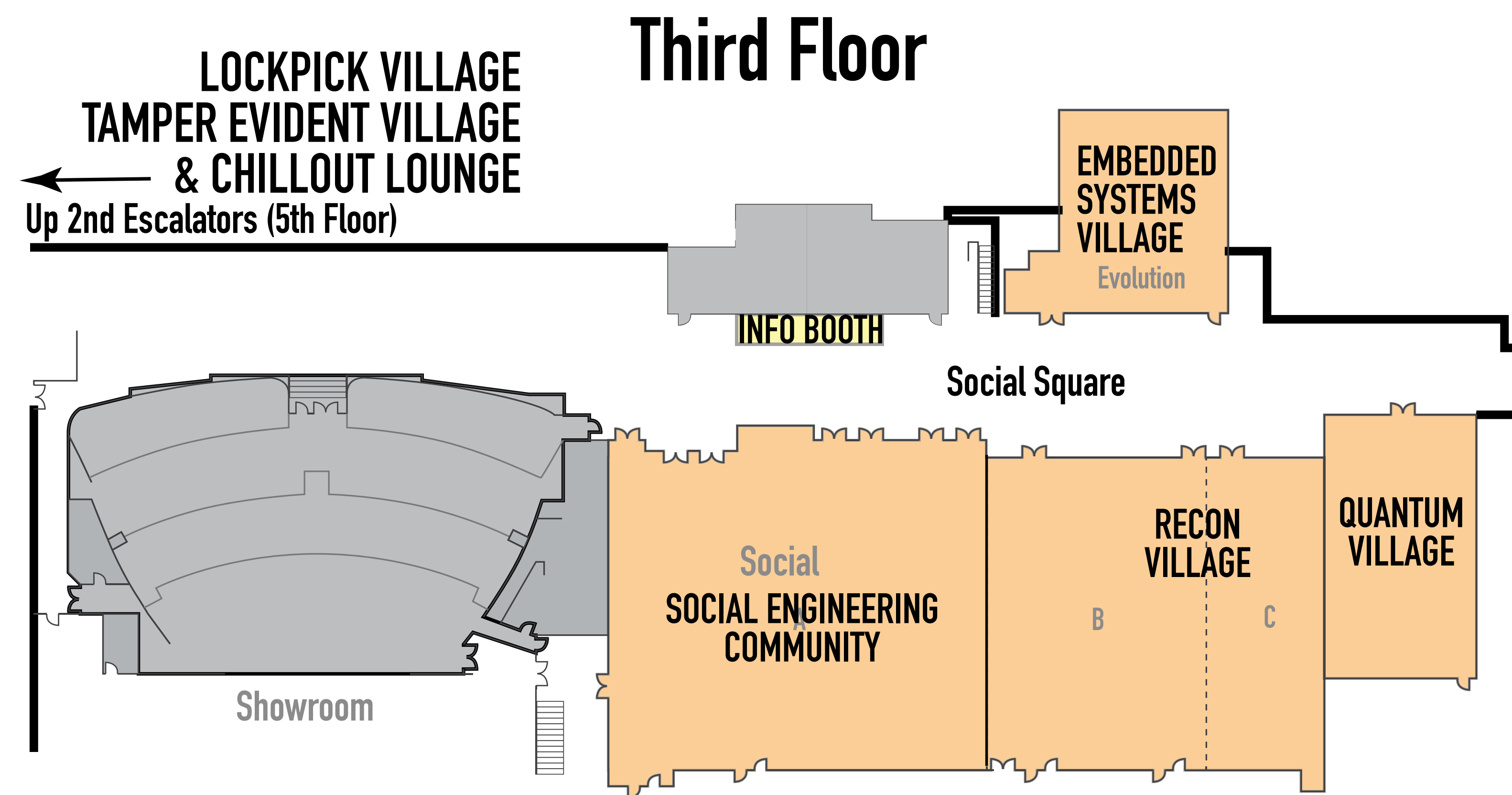



# TRAVELING BETWEEN VENUES



  
Harrah's and LINQ Hotels:  
3.5 minute walk via climate controlled walkway connecting properties to Caesars Forum

  
Caesars Palace:  
7 minute walk from the Front Desk, across the street and through the LINQ Promenade

**IN THE EVENT OF ELEVATOR OR ESCALATOR FAILURE THESE ARE THE ALTERNATE ROUTES TO USE BETWEEN VENUES.**



# LAS VEGAS MONORAIL

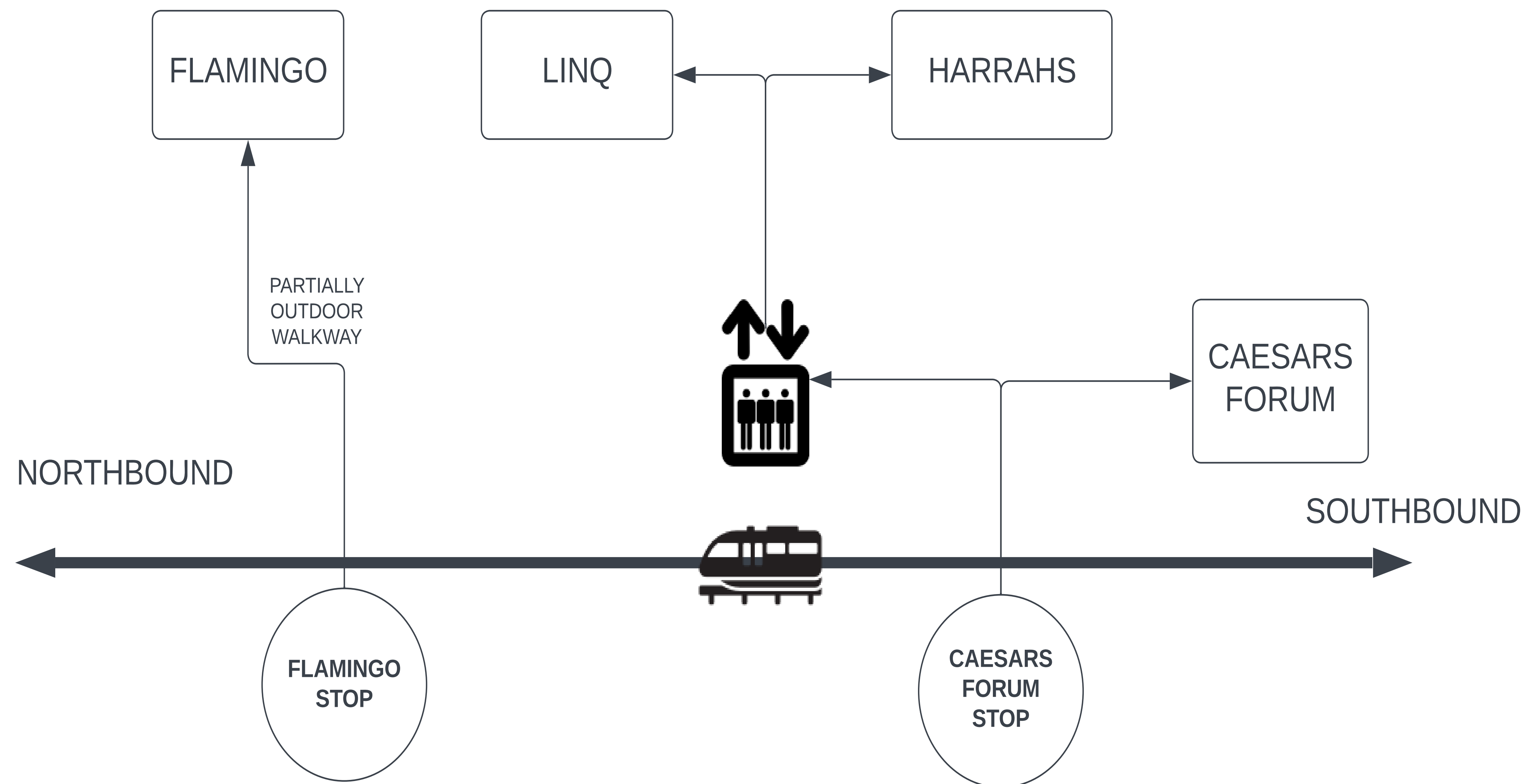

**MONORAIL FARES : \$6 ONE RIDE , \$15 ONE DAY PASS, \$26 TWO DAY PASS**  
**DISCOUNTS AVAILABLE : [HTTPS://WWW.LVMONORAIL.COM/TICKET-INFORMATION/](https://www.lvmonorail.com/ticket-information/)**  
**HOURS OF OPERATION : THU : 7AM-2 AM / FRI-SUN : 7AM-3AM**



# HDA COMMUNITY ROOM



DEF CON 31 / HDA4  
HACKERS WITH DISABILITIES  
"MAKING DEF CON AWESOMELY ACCESSIBLE"

COMMUNITY ROOM  
HARRAHS STUDIO 2-3-4  
12:00 - 20:00

DECORATION STATION FOR ADA GEAR  
COMMUNITY HANGOUT ROOM  
SAFE HARBOR ROOM  
SPECIAL EVENTS FOR HDA

FRIDAY

12:00 - ANALOG SYNTH JAM SESSION  
13:00 - LED LIGHTS FOR FUN & SAFETY!

SATURDAY

13:00 - HACKING POWER WHEELCHAIRS  
15:00 - GEEK TRIVIA WITH PRIZES FROM ADAFRUIT!







# CREDITS



**THE HDA LOGO WAS DESIGNED AND CREATED BY  
EDDIE "THE YETI" MIZE**





# CREDITS



**DEF CON HDA HACKERS WITH DISABILITIES WAS CREATED BY A.P. DELCHI**

**DEF CON 6 : FIRST DEF CON**

**DEF CON 7 : OWNED BY THE cDc : INDUCTED INTO THE NSF**

**DEF CON 7 : DJ BLACK & WHITE BALL**

**DEF CON 8-13 : DJ , ROAD CREW , GRUNT**

**DEF CON 14 : DJ BLACK & WHITE BALL**

**DEF CON 14 : SKYTALKS "HOW TO READ LOGS WITHOUT LOSING YOUR MIND"**

**DEF CON 15 : SPEAKER "MALWARE SECRETS"**

**DEF CON 16 : PARTY "THE GATHERING"**

**DEF CON 17 : PARTY "THE GATHERING II"**

**DEF CON 18 : SPEAKER "PHYSICAL SECURITY:YOU'RE DOING IT WRONG"**

**DEF CON 19 - 22 : DJ, ROAD CREW, GRUNT**

**DEF CON 22 : INDUCTED INTO THE FACES OF DEFCON MURAL**

**DEF CON 26 : GOONED - PARTIES TEAM**

**DEF CON 27 : PARTIES TEAM & HACKERS WITH DISABILITIES ( HDA 1 )**

**DEF CON 28 : CANCELLED**

**DEF CON 29 : HACKERS WITH DISABILITIES ( HDA2 )**

**DEF CON 30 : HACKERS WITH DISABILITIES ( HDA3 )**

**DEF CON 31 : HACKERS WITH DISABILITIES COMMUNITY ESTABLISHED ( HDA4 ) 5 YEAR GOON ANNIVERSARY**

